

Swingover #1: (25 Unit)



Dairy Statistics

- Farm location: Central Gippsland
- Max. cows milked: 275
- Calving pattern: Autumn - Winter
- Dairy type: Herringbone Swingover
- No. of units: 25
- Labour units employed: 2



Automation Options

- ACR's
- Out of parlour teat spray
- Automatic drafting
- Rapid exit
- Electronic cow identification
- Milk metering
- Auto plant cleaning
- Auto vat cleaning
- Auto heat detection
- Integrated herd management software



Dairy Performance

The following performance figures were calculated at peak lactation using CowTime's Milking Monitor:

- 100 Cows per operator per hour (cups on cups off)
- 1363 Litres per operator per hour (cups on cups off)
- 1125 Litres per operator per hour (total milk harvesting time)



Dairy Builder

- Shed Design: AJ & KJ Chambers
- Phone: 0427 451 583



Special or key features of this dairy

- The cows move easily through this dairy.
- They enter straight from the rear of the yard and exit at the end of the shed, no turning required.
- When cows need to be drafted they are diverted to an exit at the side of the dairy where they can either enter the vet area which is under cover or the adjoining paddock.
- The design is simple but effective.
- There is plenty of natural lighting and yet there is good protection from the elements.

Disclaimer: "CowTime Dairy Designs has been published for your information only. It is published with due care and attention to accuracy, but CowTime, its funders and representatives accept no liability if, for any reason, the information is inaccurate, incomplete or out of date. The information is a guide only and professional advice should be sought regarding the reader's specific circumstances."

Swingover #1: (25 Unit)

1. Yard Entrance
(from track looking into yard)



4. Dairy layout / cow entry
(looking from yard into dairy)



2. Holding yards
(from end looking toward dairy)



5. Inside Pit
(from holding yard end)



3. Holding yards
(from dairy looking towards rear)



6. Cow exit
(from outside shed looking into dairy exit)



Disclaimer: "CowTime Dairy Designs has been published for your information only. It is published with due care and attention to accuracy, but CowTime, its funders and representatives accept no liability if, for any reason, the information is inaccurate, incomplete or out of date. The information is a guide only and professional advice should be sought regarding the reader's specific circumstances."



CowTime Dairy Designs



Swingover #1: (25 Unit)

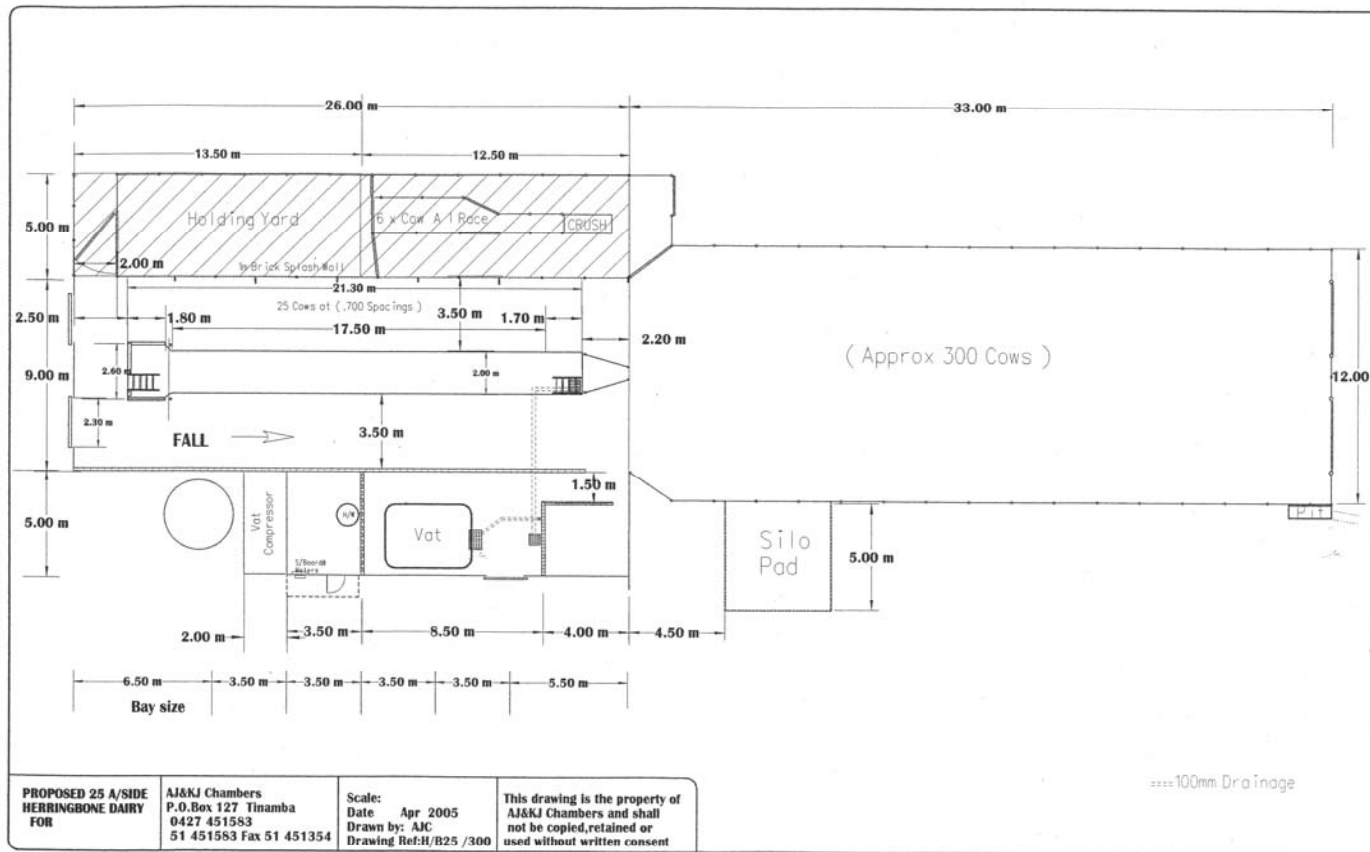

Disclaimer: "CowTime Dairy Designs has been published for your information only. It is published with due care and attention to accuracy, but CowTime, its funders and representatives accept no liability if, for any reason, the information is inaccurate, incomplete or out of date. The information is a guide only and professional advice should be sought regarding the reader's specific circumstances."